

**FRONT VIEW**

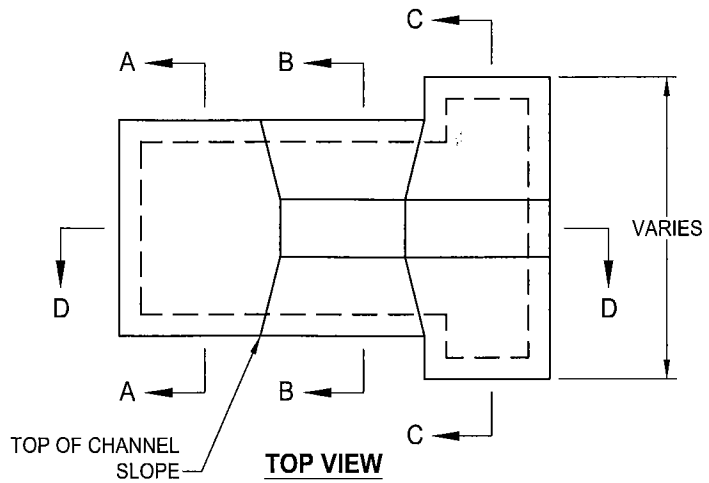

**TOP VIEW**

**NOTES:**

1. USE CLASS "B" CONCRETE OR GROUTED COBBLES AS SPECIFIED.
2. 6" x 6" -W6 x W6 WWK THROUGHOUT CONCRETE.
3. ON LINED CHANNELS APRON SHALL CONNECT TO SIDE LINING.
4. B = DITCH BOTTOM WIDTH OR AS SHOWN ON PLANS.
5. D = DITCH WATER DEPTH PLUS ONE FOOT OF FREEBOARD.
6. ADD ENERGY DISSIPATION FEATURES SUCH AS COBBLES, RIP-RAP, OR MOLDED CONCRETE AT END OF APRON.

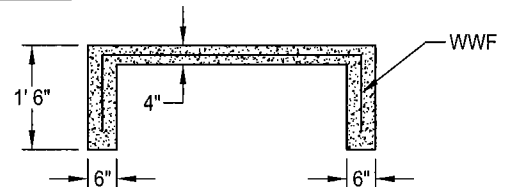

**SECTION A-A**

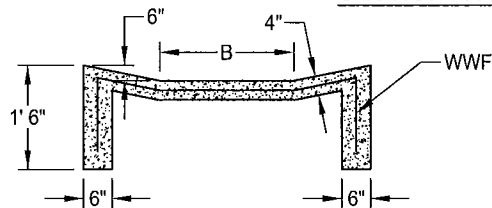

**SECTION B-B**

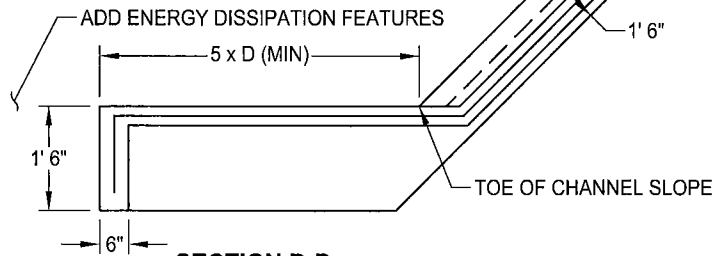
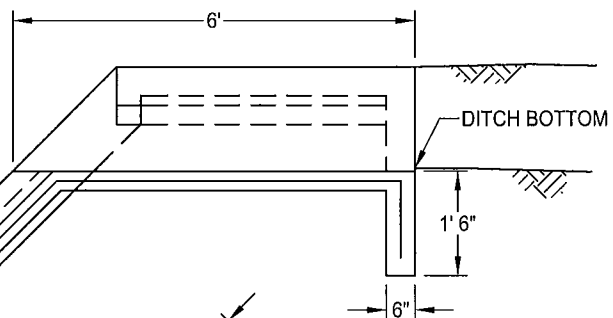

**SECTION D-D**

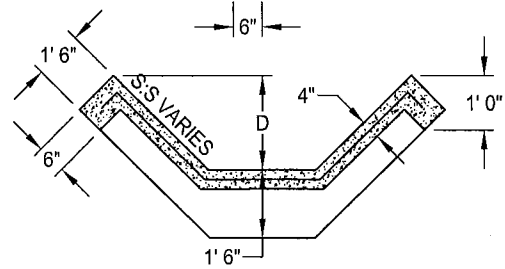

**SECTION C-C**

DATE: 01/24/2007		NOT TO SCALE		CITY OF ELK GROVE - PUBLIC WORKS		APPROVED BY:	
REVISION		BY				CITY ENGINEER	
				<b>DITCH DISCHARGE CONTROL AND APRON</b>		 <b>SD - 27</b>	